

SHIAWASSEE COUNTY 2011 APPORTIONMENT COMMISSION
April 12, 2011

The Shiawassee County Apportionment Commission was called to order at 2:00 p.m. by Lauri Braid, County Clerk

Members present: Lauri Braid, County Clerk, Tom Dwyer, County Treasurer, Randy Colbry, County Prosecutor, Sam Burwell, Republican Party Chairman and Carol Spaniola, Democratic Party Chairman

Lauri Braid called for nominations for a permanent Chairman. Tom Dwyer nominated Lauri Braid for permanent Chairman, nominations were closed and a unanimous vote was cast for Lauri Braid.

Chairman Braid called for nominations for Secretary. Tom Dwyer nominated Carol Spaniola for Secretary, nominations were closed and a unanimous vote was cast for Carol Spaniola.

It was moved by Sam Burwell, supported by Carol Spaniola to adopt the current version of Roberts Rules of Order as the rules of procedure for the commission. Motion carried.

It was moved by Carol Spaniola, supported by Tom Dwyer to forego compensation for meetings by commission members. Motion carried.

Chairman Braid read the Guidelines for Apportionment to be followed by the Commission.

Under discussion on plans it was the consensus to keep the County Commissioners at 7. Chairman Braid stated she would work on a plan to present at the next meeting and that each member who wishes to may do the same.

The next meeting was set for May 12, 2011 at 1:30 p.m. in the Commissioner Chambers, Surbeck Building, 201 N. Shiawassee Street, Corunna, MI.

Public Comment: Wayne Roszman, 804 W. Hibbard Road, Owosso

The meeting was adjourned at 2:30 p.m.



Carol Spaniola, Secretary

SHIAWASSEE COUNTY 2011 APPORTIONMENT COMMISSION
May 12, 2011

The Shiawassee County Apportionment Commission was called to order at 1:30 p.m. by Lauri Braid, County Clerk

Members present: Lauri Braid, County Clerk, Tom Dwyer, County Treasurer, Randy Colbry, County Prosecutor, Sam Burwell, Republican Party Chairman and Carol Spaniola, Democratic Party Chairman

Randy Colbry moved, supported by Carol Spaniola to approve the minutes of the April 14, 2011 meeting. Motion carried.

Lauri Braid presented a plan to the Board.

The following resolution was presented:

**RESOLUTION OF THE APPORTIONMENT COMMISSION
SHIAWASSEE COUNTY, MICHIGAN
ADOPTING THE 2011 APPORTIONMENT PLAN**

WHEREAS, the U.S. Census Bureau did duly conduct a census in the year 2010; and

WHEREAS, the population totals determined by that census for Shiawassee County, by City and Township, were submitted to the Shiawassee County Apportionment Commission by the Michigan Department of State on April 6, 2011; and

WHEREAS, the Apportionment Commission did meet and discuss options for re-apportioning the County Commission Districts for Shiawassee County; and

WHEREAS, at the May 12, 2011 meeting, by a vote of 5 to 0 an apportionment plan was adopted;

NOW, THEREFORE, BE IT RESOLVED, that the Shiawassee County Apportionment Commission does hereby adopt the attached map and boundary description as the Apportionment Plan for the Shiawassee County Board of Commissioners commencing with the Commissioner terms beginning January 1, 2013.

Sam Burwell moved, supported by Randy Colbry to approve the Resolution adopting the plan. Motion carried.

Public Comment: No Public present

The meeting was adjourned at 1:55 p.m.



Carol Spaniola, Secretary

**RESOLUTION OF THE APPORTIONMENT COMMISSION
SHIAWASSEE COUNTY, MICHIGAN
ADOPTING THE 2011 APPORTIONMENT PLAN**

WHEREAS, the U.S. Census Bureau did duly conduct a census in the year 2010; and

WHEREAS, the population totals determined by that census for Shiawassee County, by City and Township, were submitted to the Shiawassee County Apportionment Commission by the Michigan Department of State on April 6, 2011; and

WHEREAS, the Apportionment Commission did meet and discuss options for re-apportioning the County Commission Districts for Shiawassee County; and

WHEREAS, at the May 12, 2011 meeting, by a vote of 5 to 0 an apportionment plan was adopted;

NOW, THEREFORE, BE IT RESOLVED, that the Shiawassee County Apportionment Commission does hereby adopt the attached map and boundary description as the Apportionment Plan for the Shiawassee County Board of Commissioners commencing with the Commissioner terms beginning January 1, 2013.

ADOPTED
SHIAWASSEE COUNTY APPORTIONMENT
COMMISSION

DATE: MAY 12, 2011

ATTESTED: *Carol Spaniola*
CAROL SPANIOLA, SECRETARY
SHIAWASSEE COUNTY
APPORTIONMENT COMMISSION

LAURI L. BRAID
SHIAWASSEE COUNTY CLERK



May 18, 2011

Department of State
Bureau of Elections
P. O. Box 20126
Lansing, Michigan 48901-0726

Dear Madame/Sir:

Enclosed please find the 2011 Apportionment Plan for Shiawassee County that was adopted by the Reapportionment Committee on May 12, 2011. This includes the Resolution adopting the plan, a map of the districts, the district populations and written descriptions of the district boundaries.

Thank you for your attention in this matter. If you need further information or have any questions, please contact me.

Sincerely,

Lauri L. Braid
Shiawassee County Clerk

Enclosures

CC: Tom Dwyer, County Treasurer
Randy Colbry, Prosecuting Attorney
Carol Spaniola, Democratic Party Chair
Sam Burwell, Republican Party Chair

**RESOLUTION OF THE APPORTIONMENT COMMISSION
SHIAWASSEE COUNTY, MICHIGAN
ADOPTING THE 2011 APPORTIONMENT PLAN**

WHEREAS, the U.S. Census Bureau did duly conduct a census in the year 2010; and

WHEREAS, the population totals determined by that census for Shiawassee County, by City and Township, were submitted to the Shiawassee County Apportionment Commission by the Michigan Department of State on April 6, 2011; and

WHEREAS, the Apportionment Commission did meet and discuss options for re-apportioning the County Commission Districts for Shiawassee County; and

WHEREAS, at the May 12, 2011 meeting, by a vote of 5 to 0 an apportionment plan was adopted;

NOW, THEREFORE, BE IT RESOLVED, that the Shiawassee County Apportionment Commission does hereby adopt the attached map and boundary description as the Apportionment Plan for the Shiawassee County Board of Commissioners commencing with the Commissioner terms beginning January 1, 2013.

ADOPTED
SHIAWASSEE COUNTY APPORTIONMENT
COMMISSION

DATE: MAY 12, 2011

ATTESTED: Carol Spaniola
CAROL SPANIOLA, SECRETARY
SHIAWASSEE COUNTY
APPORTIONMENT COMMISSION

COMMISSIONER DISTRICTS FOR SHIAWASSEE COUNTY

January 1, 2013 thru December 31, 2022



- | | |
|---|--|
| <ul style="list-style-type: none"> District 1 (Pop. 9,870) District 2 (Pop. 9,875) District 3 (Pop. 10,246) District 4 (Pop. 9,864) | <ul style="list-style-type: none"> District 5 (Pop. 10,358) District 6 (Pop. 10,110) District 7 (Pop. 10,325) |
|---|--|

**SHIAWASSEE COUNTY
2011 APPORTIONMENT PLAN**

District 1	Middlebury Twp, Fairfield Twp, Rush Twp, Owosso Twp Pcts 1 & 2, Owosso City 1-1	9,870 -222
District 2	Owosso City Pcts 2-1, 2-2, 2-3 and 2-4	9,875 -217
District 3	Hazelton Twp, New Haven Twp, Corunna City, Caledonia Twp (new pct 1 -2,575), Venice Twp (new pct 1 - 772)	10,246 +154
District 4	Vernon Twp, Durand City Venice Twp (new pct 2 - 1,806)	9,864 -228
District 5	Burns Twp, Antrim, Twp, Shiawassee Twp, Caledonia Twp (new pct 2 - 1,900)	10,358 +266
District 6	Bennington Twp, Sciota Twp, Laingsburg City Owosso Twp Pct 3, Owosso City 6-1	10,110 +18
District 7	Perry Twp, Perry City, Woodhull Twp.	10,325 +233

Total Population 70,648
7 equal districts = 10,092

District 5 **Burns Twp, Antrim, Twp, Shiawassee Twp,** **10,358** **+266**
Caledonia Twp (new pct 2 - 1,900)

Beginning at the corner of Miller Road and Sheridan Road south to Lovejoy Road, then west to Cork Road, then north to Cook Road continuing north to the Owosso City limits. Follow the City limits around on the east side of the City to Corunna Avenue, then Corunna Avenue east to the Corunna City limits following the City limit boundary line on the south side around to the southbank of the Shiawassee River on the east side of the City limits then east on the southbank of the Shiawassee River to Geeck Road, south to Miller Road, then east to Sheridan Road.

District 6 **Bennington Twp, Sciota Twp, Laingsburg City** **10,110** **+18**
Owosso Twp (pct 3), Owosso City 6-1

Beginning at the corner of Hibbard Road and Meridian Road east to Baldwin Road, north to south of the south side of Krouse Road, east to Chestnut Street, north to M-21 east to Chipman Street, south to Stewart Street, east to Cedar Street, south to south of the south side of Krouse Road east to Cook Road, south to Miller Road west to the County line, north to Hibbard Road.

District 7 **Perry Twp, Perry City, Woodhull Twp.** **10,325** **+233**

Beginning at the northwest corner of Woodhull Township proceed along the Woodhull Township line to Miller Road including only the south side of Miller Road to the eastern Perry Township line then south to Lovejoy Road, then west on Lovejoy Road to Meridian Road, then north to the point of beginning.

PLAN E

OWOSSO MAP

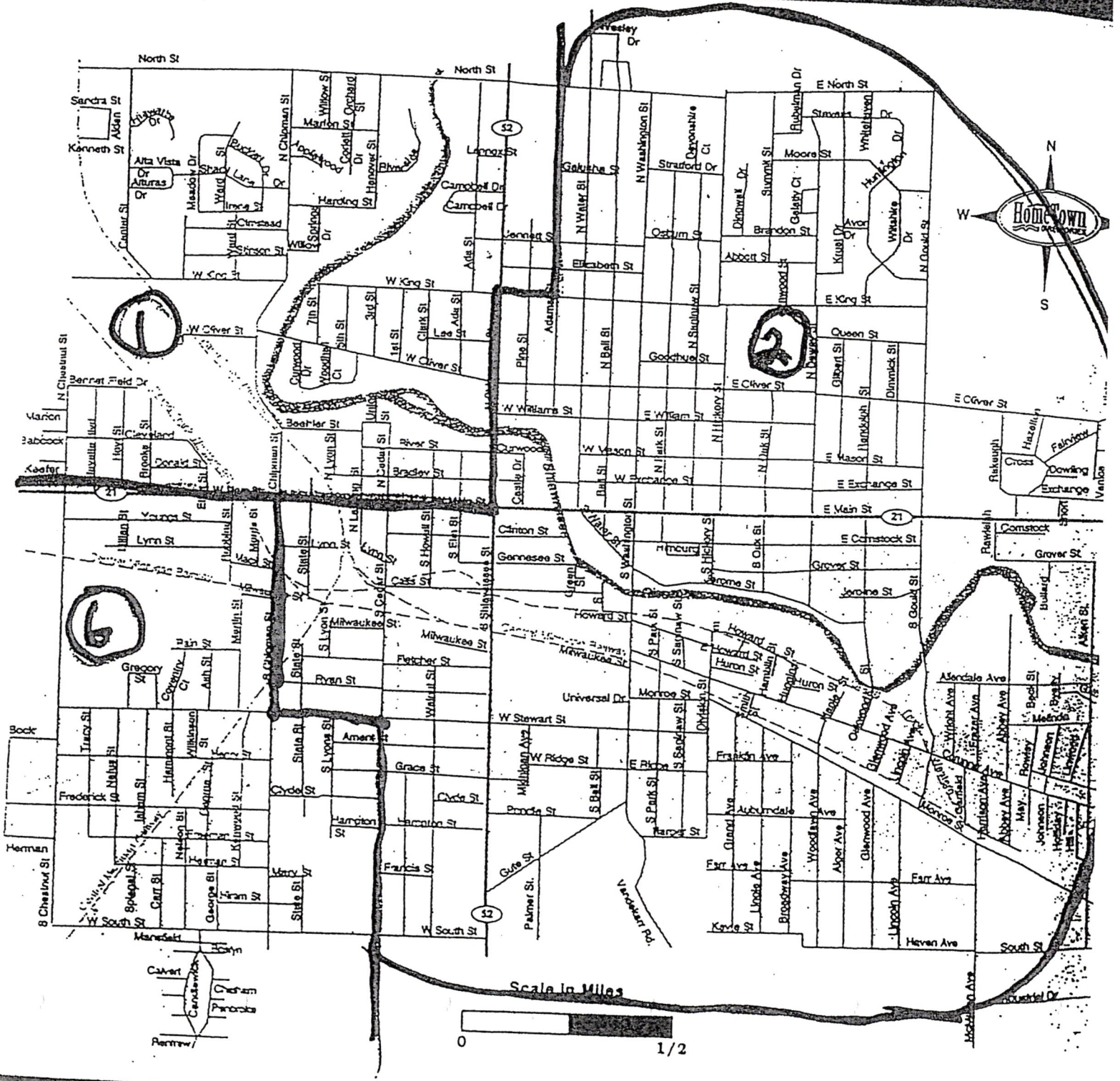

0 1/4 1/2 Miles

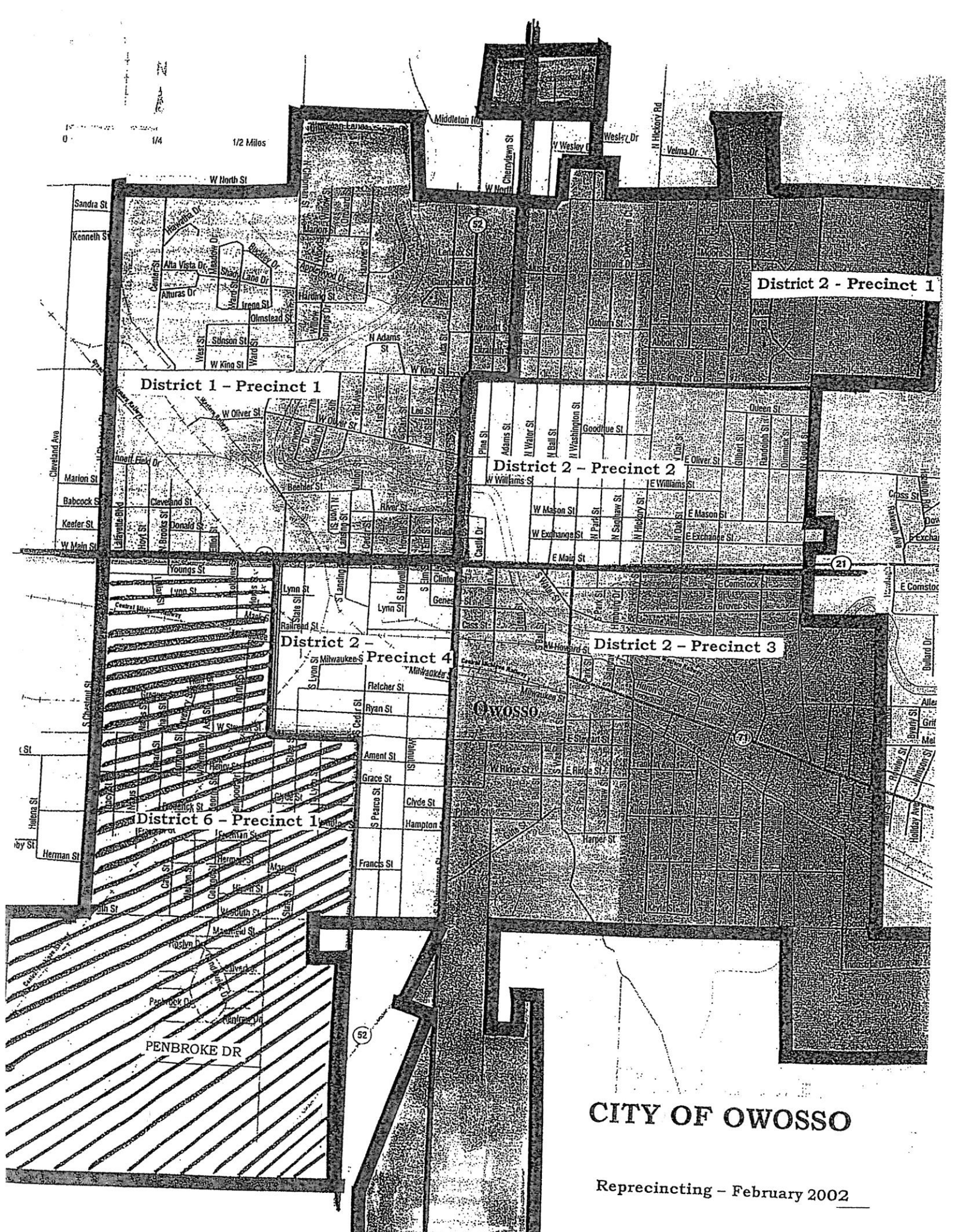

District 2 - Precinct 1

District 1 - Precinct 1

District 2 - Precinct 2

District 2 - Precinct 4

District 2 - Precinct 3

District 6 - Precinct 1

PENBROKE DR

OWOSSO

CITY OF OWOSSO

Reprecincting - February 2002

District 1 - Precinct 1

(County Commissioner District No. 1)

Begin on West North Street at the West Corporate Limits, East along the North Corporate Limits to Chipman Street, North on Chipman Street 525.84' to the North Corporate Limits, East along North Corporate Limits to the Shiawassee River, South along the Shiawassee River to the North Corporate Limits, East along the North Corporate Limits to Adams Street, South on Adams Street to King Street, West on King Street to Shiawassee Street, South on Shiawassee Street to Main Street, West on Main Street to West Corporate Limits, North along the West Corporate Limits to the Point of Beginning, also including 1464 and 1466 North M-52.

District 2 - Precinct 1

(County Commissioner District No. 2)

Begin on North Street at Adams Street, East along the North Corporate Limits to the East Corporate Limits (Gould Street), South along the East Corporate Limits to King Street, West on King Street to Shiawassee Street, North on Shiawassee Street to North Street, East on North Street to the Point of Beginning, also including 202 West North Street.

District 2 - Precinct 2

(County Commissioner District No. 2)

Begin on King Street at Shiawassee Street, East along King Street to Gould Street, South on Gould Street to Main Street, West on Main Street to Shiawassee Street, North on Shiawassee Street to Point of Beginning.

District 2 - Precinct 3

(County Commissioner District No. 2)

Begin on Main Street at Shiawassee Street, East along Main Street to Gould Street, South on Gould Street to the Shiawassee River, Easterly along the Shiawassee River to the East Corporate Limits, South on the East Corporate Limits to South Street, East on South Street to the East Corporate Limits, South along the East Corporate Limits to the South Corporate Limits, West along the South Corporate Limits to Palmer Street, South on Palmer Street to South Corporate Limits, West on South Corporate Limits to Corporate Limits, North on the Corporate Limits to Shiawassee Street, North on Shiawassee Street to Point of Beginning, also including 1500-1507 Palmer Street.

District 2 - Precinct 4







(County Commissioner District No. 2)

Begin on Main Street at Chipman Street, East on Main Street to Shiawassee Street, South on Shiawassee Street to South Street, West on South Street to Cedar Street, North on Cedar Street to Stewart Street, West on Stewart Street to Chipman Street, North on Chipman Street to Point of Beginning.

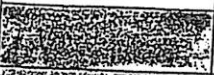
District 6 - Precinct 1

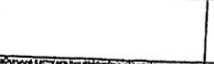
(County Commissioner District No. 6)

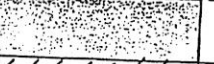
Begin on Main Street at West Corporate Limits, East on Main Street to Chipman Street, South on Chipman Street to Stewart Street, East on Stewart Street to Cedar Street, South on Cedar Street to South Street, West along South Street to a point 264' West of Chipman Street, thence South on Corporate Limits 330', thence East on Corporate Limits to Chipman Street, South on Chipman Street to South Corporate Limits, thence West along South Corporate Limits to West Corporate Limits, North along West Corporate Limits to South Street, East on South Street to Chestnut Street, North on Chestnut Street to Point of Beginning.

Color Key	District / Precinct	Polling Place	# of Registered Voters
	1-1	Central School	2103
	2-1	Emerson School	1616
	2-2	Emerson School	1685
	2-3	Washington School	2354
	2-4	Bryant School	929
	6-1	Bryant School	1742

LAURI L. BRAID
SHIAWASSEE COUNTY CLERK



January 30, 2012

Department of State
Bureau of Elections
P. O. Box 20126
Lansing, Michigan 48901-0726

Dear Madame/Sir:

Enclosed please find the Amended written descriptions of the district boundaries for the 2011 Apportionment Plan for Shiawassee County that was adopted by the Reapportionment Committee on May 12, 2011. There was an error in the written description. This amendment in no way changes the Resolution adopting the plan, the map of the districts or the district populations.

Thank you for your attention in this matter. If you need further information or have any questions, please contact me.

Sincerely,

A handwritten signature in black ink, appearing to read "L. Braid", is written over the typed name.

Lauri L. Braid
Shiawassee County Clerk

Enclosures

CC: Tom Dwyer, County Treasurer
Randy Colbry, Prosecuting Attorney
Carol Spaniola, Democratic Party Chair
Sam Burwell, Republican Party Chair

**SHIAWASSEE COUNTY
2011 APPORTIONMENT PLAN**

District 1 Middlebury Twp, Fairfield Twp, Rush Twp, Owosso Twp (pcts 1 & 2), Owosso City 1-1 9,870 -222

Beginning at the southwest corner of Middlebury Township proceed north along the county line to Johnstone Road (north county line) east to M-52 south along Rush Township line to the Owosso City limit, west to Adams Street south to King Street, then west to M-52 proceed south to M-21, then west to the City limits. Following the City limits south to Krouse Road, then west including both sides of Krouse Road to Baldwin Road south to Hibbard Road west to the County Line and point of beginning.

District 2 Owosso City Precincts 2-1, 2-2, 2-3 and 2-4 9,875 -217

Beginning at the corner of M-21 and Shiawassee Street going west to Chipman Street, then south on Chipman to Stewart, then east to Cedar Street, then south to the City limits then east to Aiken Road, then north following City limits to North Street, then west to Adams Street, south to King Street then west to Shiawassee Street south to point of beginning.

District 3 Hazelton Twp, New Haven Twp, Corunna City, Caledonia Twp (new pct 1 -2,575), Venice Twp (new pct 1 - 772) 10,246 +154

Beginning at the corner of Sheridan Road and Johnstone Road proceed west to M-52 go south following the Township line to Hickory Road to Owosso City limits east on North Street to Gould Street south to the north bank of the Shiawassee River east to the east side of Homestead Drive then southeast to the east side of Union Avenue, south on Union Avenue to Corunna Avenue, then east on the north side of Corunna Avenue to Corunna City limits following the south side of the City limits around to the Northbank of the Shiawassee River on the east side of the City limits then going east along the Northbank of the Shiawassee River to Geeck Road then north on Geeck Road to M-21 east to Sheridan Road, north to Johnstone Road.

District 4 Vernon Twp, Durand City Venice Twp (new pct 2 - 1,806) 9,864 -228

Beginning at the corner of Miller and Sheridan Roads go north to M-21, then west on M-21 to Geeck Road, then south to Miller Road, then east to Sheridan Road.

District 5 **Burns Twp, Antrim, Twp, Shiawassee Twp,** **10,358** **+266**
Caledonia Twp (new pct 2 - 1,900)

Beginning at the corner of Miller Road and Sheridan Road south to Lovejoy Road, then west to Cork Road, then north to Cook Road continuing north to the Owosso City limits. Follow the City limits around on the east side of the City to the southbank of the Shiawassee River, then east to the west side of Homestead Drive, then southeast to the west side of Union Avenue, south on the Westside of Union Avenue to Corunna Avenue, then Corunna Avenue east to the Corunna City limits following the City limit boundary line on the south side around to the southbank of the Shiawassee River on the east side of the City limits then east on the southbank of the Shiawassee River to Geeck Road, south to Miller Road, then east to Sheridan Road.

District 6 **Bennington Twp, Sciota Twp, Laingsburg City** **10,110** **+18**
Owosso Twp (pct 3), Owosso City 6-1

Beginning at the corner of Hibbard Road and Meridian Road east to Baldwin Road, north to south of the south side of Krouse Road, east to Chestnut Street, north to M-21 east to Chipman Street, south to Stewart Street, east to Cedar Street, south to south of the south side of Krouse Road east to Cook Road, south to Miller Road west to the County line, north to Hibbard Road.

District 7 **Perry Twp, Perry City, Woodhull Twp.** **10,325** **+233**

Beginning at the northwest corner of Woodhull Township proceed along the Woodhull Township line to Miller Road including only the south side of Miller Road to the eastern Perry Township line then south to Lovejoy Road, then west on Lovejoy Road to Meridian Road, then north to the point of beginning.

How are county commissioner districts created?

[John Amrhein & Eric Walcott, Michigan State University Extension](#) - June 2, 2021

Updated from an original article written by John Amrhein, Michigan State University Extension.

Share Save  Tweet  Share  Print  Email

The county apportionment process takes place every 10 years following the census, to draw county commission districts.

County commissioners serve districts where they live, geographic boundaries meant to ensure that the residents of each county have equal representation on their county board. There are currently 622 county commissioners serving Michigan's 83 counties. The process of drawing county commissioner districts, called apportionment, takes place every 10 years following the census. Since 2020 was a census year, the apportionment process will take place this year in all 83 Michigan counties.

In all but one of Michigan's 83 counties, the districts are designed, or apportioned, by the apportionment commission. In counties that have adopted the optional unified form of county government and has an elected county executive, the apportionment commission is the county board of commissioners. Oakland County is the only county currently fitting that description.

Michigan law, MCL 46.403, defines the apportionment process. The apportionment commission is made up of the county clerk, the county treasurer, the county prosecuting attorney, and the county chairpersons of the two political parties receiving the greatest number of votes cast for secretary of state in the last preceding general election. Since this law was written in 1966, following the U.S. Supreme Court's "one person, one vote" ruling, that has always been the Republican and Democratic parties.

Michigan law charges the apportionment commission with determining the number of districts within ranges prescribed in the law. The number of commissioners in each county ranges from 5-21, with the maximum number set for counties based on their total population, in MCL 46.402. The law also charges the commission to do their work within 60 days of the publication of the latest United States decennial census.

MCL 46.404 defines eight guidelines for apportionment and lists them in order of importance. The guidelines are:

1. Single member districts of “...as nearly of equal population as practicable.”
2. Contiguous – a district must be entirely connected
3. Compact and “...as nearly square shape as is practicable.”
4. Can’t combine parts of a township and parts of a city unless “...needed to meet the population standard.”
5. Can’t divide townships, cities, or villages unless “...necessary to meet the population standard.”
6. Voting precincts can only be divided if “...necessary to meet the population standard.”
7. Residents of state institutions who can’t register to vote are not to be included in the count.
8. “Districts shall not be drawn to effect partisan political advantage.”

Once the apportionment commission adopts a map, it is filed with the county clerk, forwarded to the Secretary of State, and made available to voters at no cost. The law gives registered voters the right to petition the court of appeals to review the plan to determine if it meets the requirements, and the findings of the appeals court may also be appealed first to the Court of Appeals, and if necessary, to the Michigan Supreme Court.

As a public body, meetings of the Apportionment Commission are subject to the Open Meetings Act, and residents have a right to attend meetings and provide public comment.

Residents interested in following the progress of their county apportionment process should visit their county website for more information.

The newly drawn districts will be used for commissioner elections in 2022 through 2030, when the results of the 2030 census will be used to create new districts.

Michigan State University Extension provides educational programs for elected and appointed officials in Michigan and also provides programs for youth about government through 4-H programs. Contact your county MSU Extension office for more information or check out our website.

This article was published by **Michigan State University Extension**. For more information, visit <https://extension.msu.edu>. To have a digest of information delivered straight to your email inbox, visit <https://extension.msu.edu/newsletters>. To contact an expert in your area, visit <https://extension.msu.edu/experts>, or call 888-MSUE4MI (888-678-3464).

extension.msu.edu

MSU is an affirmative-action, equal-opportunity employer, committed to achieving excellence through a diverse workforce and inclusive culture that encourages all people to reach their full potential.

Michigan State University Extension programs and materials are open to all without regard to race, color, national origin, gender, gender identity, religion, age, height, weight, disability, political beliefs, sexual orientation, marital status, family status or veteran status. Issued in furtherance of MSU Extension work, acts of May 8 and June 30, 1914, in cooperation with the U.S. Department of Agriculture. Quentin Tyler, Interim Director, MSU Extension, East Lansing, MI 48824. This information is for educational purposes only. Reference to commercial products or trade names does not imply endorsement by MSU Extension or bias against those not mentioned.

The 4-H Name and Emblem have special protections from Congress, protected by code 18 USC 707.

We comply with the Federal Trade Commission 1998 Children's Online Privacy Protection Act (COPPA) (<https://www.ftc.gov/enforcement/rules/rulemaking-regulatory-reform-proceedings/childrens-online-privacy-protection-rule>).

Search

Coming this Fall: Free County Commissioner Redistricting Tool

In order to assist counties in drawing their county commission districts more quickly and efficiently, BOE is working with the Michigan Center for Shared Solutions (CSS), the state agency that maintains geographic information systems (GIS) for the state of Michigan, to create a web-based reapportionment application for County Commissioner Districts (CCD). Counties will be able to utilize this tool free of charge in their reapportionment process. This may assist counties that might otherwise need to purchase additional software or programs for county commissioner district reapportionment. BOE's goal is to have this tool available for county use on September 1, 2021. For more information on the redistricting process, see the following article.

The web-based CCD tool will contain the following:

- 2020 Census Blocks and demographic data.
- Ability to create multiple plans for evaluation purposes with population and other evaluation criteria.
- Ability to finalize plan and create descriptions and maps needed for final reporting.
- Ability to export final shapefile for use in other applications and maps.

Census Data, Redistricting, and 2022 Statewide Elections

Under Proposal 2018-2, Michigan's U.S. House of Representatives, State Senate, and State House districts will be drawn by an Independent Citizens Redistricting Commission (ICRC). Because the United States Census Bureau has announced that redistricting data, which normally would have been available in March 2021, will not be available until September 2021, the ICRC and the Secretary of State have filed a lawsuit in the Michigan Supreme Court requesting that the deadlines for finalizing districts be extended from the current Fall 2021 deadline to January 2022.

January districts will accelerate the timeline under which new districts must be incorporated into the Qualified Voter File (QVF) so that all voters are properly reassigned and given the proper ballots for the August and November 2022 elections. After new districts for State House, State Senate, and U.S. House of Representatives are established, the Bureau of Elections (BOE) must update the voter registration records for any registered voters who have moved into a different district. Although only the three categories of districts listed above are drawn by the ICRC, the process for drawing other districts is also affected by the Census delay.

Counties can begin drawing commissioner districts as soon as they receive the Census redistricting data in September 2021. However, until after state legislative and

congressional districts are finalized counties will not be able to ensure they draw county commission districts that are wholly contained within a single state legislative or congressional district.

Additionally, precincts can be established before state legislative and congressional districts are drawn (they must be established by April 4, 2022, MCL 168.661), but doing so before other districts are drawn does not allow municipalities to avoid “precinct splits” – to the extent possible, voters in the precinct should receive the same ballot style with the same races, as opposed to a “split” precinct where voters may get different ballot styles.

Municipalities may have requirements in their city or township charter that requires municipal districts to be drawn subject to earlier deadlines that may be affected, directly or indirectly, by the delay of the Census redistricting data from March to September. Local clerks should consult with their local counsel on how to address these deadlines given Census delays. The ICRC’s lawsuit may be a helpful point of reference in this discussion.

The BOE completes the process of reassigning voters to new districts using the QVF and the QVF Street Index, which includes registration records for all registered voters and the list of addresses with registered voters. After BOE receives the new district lines, it must move any voter whose district has changed into the new district in the voter’s QVF record. Many moves can be completed using a “global” or “batch” software command process, in which a set of addresses in a given area can all be moved at once. However, a significant number of registrations need to be adjusted or reviewed manually. This is particularly likely to be the case when district lines cut through municipalities or street segments. Some registrations need to be moved manually, one address or street segment at a time.

Although the 2022 State Primary election does not occur until August 2, 2022, voters must be assigned to new state legislative and Congressional districts no later than April 19, 2022, which is the statutory filing deadline for candidates running for this office. This is because, in order to sign a candidate petition, a petition signer must live in the district, and the QVF is used to determine whether voters live in the district when reviewing petition signatures.

After districts are drawn, the Bureau of Elections plans to start with the largest districts – Congressional, State Senate, then State House – in reassigning address through the QVF. As these districts are added and voters are reassigned, BOE will work with local election clerks to verify that the district information is correct. To do this, BOE will provide the changes to the Street Index that have been made for each clerk’s jurisdiction and ask the clerk to review the changes. If clerks identify any errors, either in the district lines that have been added to the street index or the specific assignments of any voter registration records to the new districts, BOE will review these changes and make any needed corrections.

In adding county and municipal boundaries to the Street Index and reassigning voters, BOE will work with county and local clerks to review the boundaries and voter reassignments. County clerks will review county commission district reassignments, and city or township clerks will review precinct boundary changes and other municipal districts if applicable.

Precinct boundary reassignment and review takes multiple months. To avoid disrupting clerks with May 2022 elections, BOE will start with jurisdictions that do not have a May 2022 election and complete precinct reassignments for jurisdictions with May elections after the May election is complete. Precinct boundaries do not need to be completed before candidate filing deadlines, which do not depend on knowing a petition-signer's precinct, but they do need to be completed before ballots are printed and mailed in June 2022.

Historically, the process of reassigning districts in QVF takes approximately six months. The greatest amount of time is attributable to the manual adjustments of addresses into new districts and manual review; even if this is a minority of addresses, it could still number in the hundreds of thousands needing manual review. The manual process is critical to ensure that every voter gets the correct ballot.

BOE will make a free county commissioner district redistricting tool to streamline that aspect of the process (for more information, see above). BOE is also currently evaluating ways to speed up the timeline during which it incorporates district boundaries and reassigns districts to voters. At this time, BOE does not yet know the extent to which these changes will be possible and the extent to which they may speed up the timeline.